

SURVEY OF PROPERTY

LOTS 144 & 145

Map Of

OLYMPIC HEIGHTS

Filed May 3, 1912 as map no. 445

Situate

Town Of East Hampton
Suffolk County, New York

SCALE: 1" = 20'

AREA: 4.760 sq.ft.
or 0.1093 acres

Certified only to:

George Kelly

COVERAGE CALCULATIONS

Existing Building Coverage: 970 sq.ft. (20.38%)
Permitted Building Coverage: 952 sq.ft. (20%)

Existing Total Lot Coverage: 1,527 sq.ft. (32.08%)
Permitted Total Lot Coverage: 2,380 sq.ft. (50%)
*Total Lot Coverage Includes Driveways

- ▲ indicates found stake.
- indicates set iron spike in fence.
- indicates set 12" iron pin.

NOTES:

1. Unauthorized alteration or addition to a survey map bearing a licensed land surveyors seal is a violation of section 7209, sub-division 2 of the N.Y. State Education Law.
2. Only copies from the original of this survey marked with an original of the land surveyor's embossed seal or inked seal shall be considered to be valid copies.
3. Certifications indicated hereon signify that this survey was prepared in accordance with the existing Code of Practice for Land Surveys adopted by the N.Y. State Association of Professional Land Surveyors. Said certifications shall run only to the person for whom the survey is prepared, and on his behalf to the Title company, governmental agency and Lending institution listed hereon, and to the assignees of the lending institution. Certifications are not transferable to additional institutions or subsequent owners.
4. Underground improvements or encroachments, if any, are not shown hereon.
5. The existence of right of ways, wetlands and/or easements of record, if any, not shown are not guaranteed.
6. All natural features shown on survey, including but not limited to Bluff Crest, Clearing, and Wetlands should be verified with the appropriate regulatory agency.



THREE MILE HARBOR ROAD

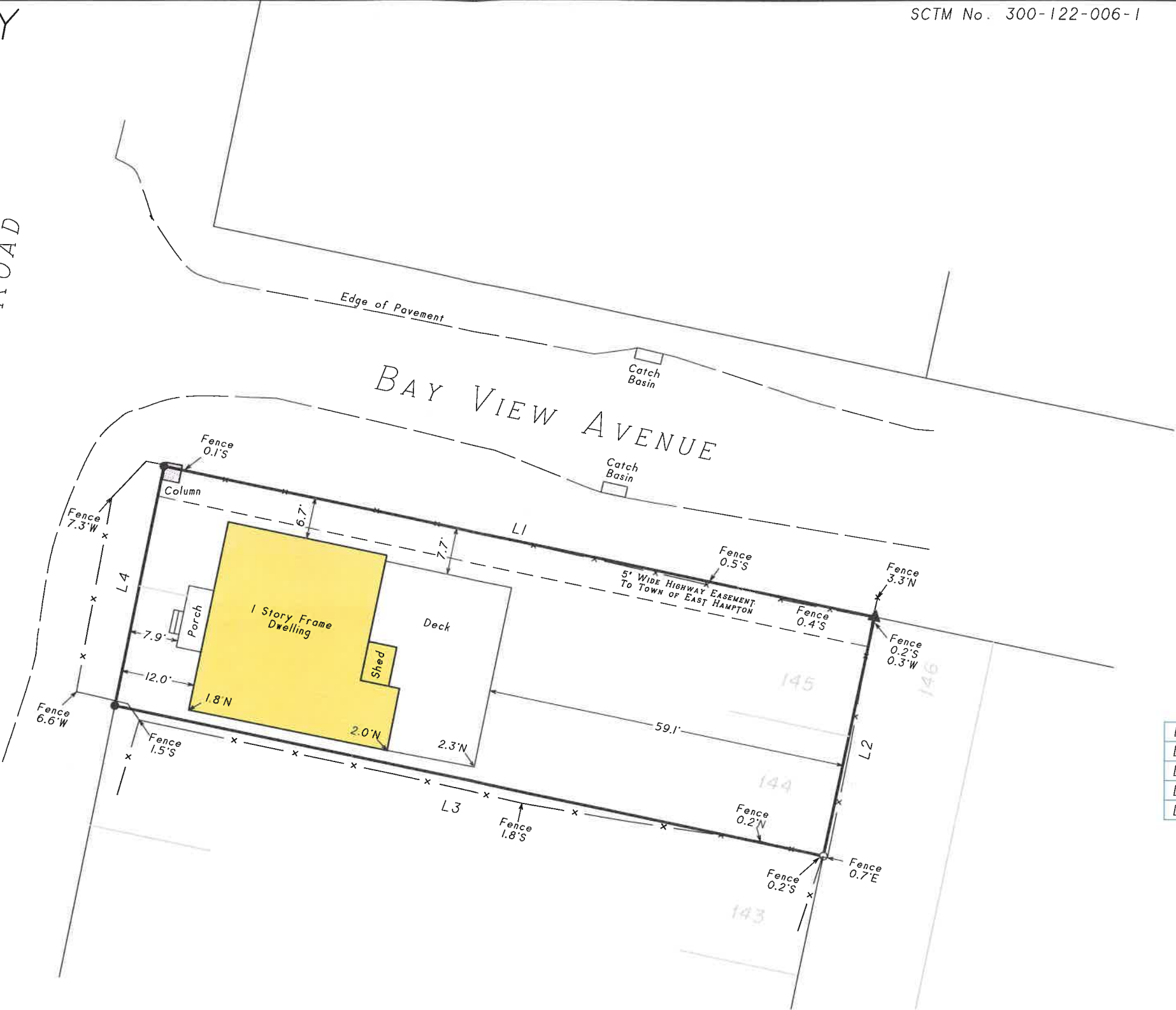

LINE	BEARING	DISTANCE
L1	S 78°04'47"E	119.16'
L2	S 11°55'13"W	40.00'
L3	N 78°04'47"W	118.83'
L4	N 11°27'00"E	40.00'

Not a valid copy unless marked
with original land surveyor's
embossed seal & signature



November 5, 2020: Update fence



Surveyed: October 16, 2020
David L. Saskas
N.Y.S. Lic. No. 049960

Saskas Surveying Company, P.C.
124 Cedar Street
East Hampton, New York 11937
(631) 324-6917 FAX 329-4768